

# Gordie Howe International Bridge

# MOMENTUM

Quarterly Newsletter issued by: Windsor-Detroit Bridge Authority  
August 2025

The Gordie Howe International Bridge project between Windsor, Ontario and Detroit, Michigan will help move goods and people more efficiently at this important trade gateway. Managed by Windsor-Detroit Bridge Authority (WDBA) and working in collaboration with the State of Michigan, the project is being delivered through a public-private partnership (P3) which will see Bridging North America (BNA) design, build, finance, operate and maintain the bridge.

.....

## IN THIS EDITION

- Our Intelligent Transportation System
- People Profile
- Green Street Reconstruction
- In the Community
- New Community Pier in Sandwich
- Ohio Freight Conference
- Kid Zone

## CONTACT US

Have a question about the Gordie Howe International Bridge project?

Meet with our team at our Sandwich Community Office at 3201 Sandwich St. or Southwest Detroit Community Office at 7744 W Vernor Hwy.

Office hours can be found on [GordieHoweInternationalBridge.com](http://GordieHoweInternationalBridge.com).

Call us toll-free at 1-844-322-1773, email us at [info@wdbridge.com](mailto:info@wdbridge.com), or message us through any of the project social media accounts.



## OUR INTELLIGENT TRANSPORTATION SYSTEM

Providing efficiencies at the Windsor-Detroit trade gateway is an important part of the Gordie Howe International Bridge project. The use of Intelligent Transportation Systems (ITS) is one way that efficiencies will be achieved. ITS includes advanced technologies that use electronics, computers, communication and sensing devices. The project's ITS components will support the needs for traffic operation and management for the bridge, the two ports of entry and the connection to I-75. A comprehensive ITS design allows the project's traffic management systems to fit seamlessly with the approach roads in Ontario and Michigan.

### Examples of ITS on the project:

- Advanced Traffic Management System (ATMS)
- Traffic Surveillance System
- Vehicle Detection and Classification System
- Travel Time Detection System
- Lane Control System
- Dynamic Message Sign System
- Connected Vehicle System
- Road Weather Information System (RWIS)

The project's Traffic Management Center is located at the Canadian Port of Entry and includes a traffic surveillance system to monitor traffic conditions by collecting data like speed and volumes for different vehicle classifications and also providing alerts when incidents occur. The data collected can also be used to forecast future traffic impacts as well as crossing usage statistics.

Vehicle detectors at toll lanes and primary inspection lanes provide queue length information to assist lane operations. To help calculate accurate travel and wait times, Bluetooth detectors collect individual vehicle entry and exit time stamps when it passes a specific location.

Road Weather Information Systems monitor pavement and weather conditions close to the road surface to help predict when the road surface may become slippery. Road maintenance staff use this information to help determine when de-icing materials should be applied to prevent slippery conditions. The RWIS stations are located on both ports of entry and the bridge and are integrated with the traffic management system to allow automatic information dissemination.

# PEOPLE PROFILE

## MEET CHRISTINA VICKERY

Christina is the Associate Vice President of Project Delivery at Windsor-Detroit Bridge Authority. She attended McMaster University in Hamilton, Ontario and graduated from Civil Engineering, Structural/Geotechnical. She was born and raised in Chatham-Kent and after moving away for school, made her way to the Windsor region to work on the Rt. Hon. Herb Gray Parkway project. Following the parkway's substantial completion, she joined the Gordie Howe International Bridge project.

### Q. What type of work are you doing on the project?

I oversee our contract administration, project controls (cost, schedule, risks and issues), performance management and reporting efforts on behalf of the Capital Delivery team.

### Q. What is the most rewarding part of working on the project?

Aside from contributing to the delivery of this iconic infrastructure project, it has been most rewarding to build and develop a strong team of impressive individuals with diverse backgrounds by taking a continuous improvement approach to everything we do.

### Q. What do you wish other people knew about the project?

There is so much more to this project than just a bridge. The Ports of Entry are mega projects themselves, and there are complex networks and systems that the team is busy finalizing on both sides of the border to prepare for a smooth transition into operations.

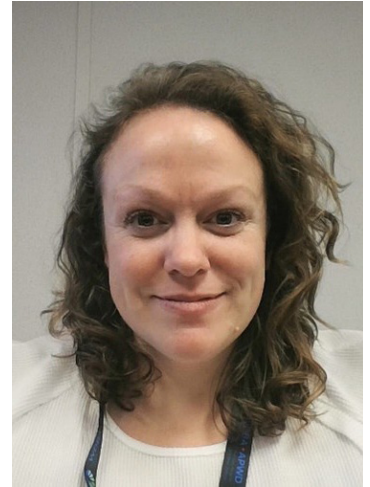

**CHRISTINA VICKERY**  
Associate Vice President of Project Delivery

## GREEN STREET RECONSTRUCTION

The construction of a key local road feature, the Green Gateway Corridor, is now underway. The corridor includes reconstruction of Green Street in Southwest Detroit from Fort Street to Jefferson Avenue that will result in realignment. A greenway will be constructed to connect pedestrians and cyclists from the Gordie Howe International Bridge over the Green Street road bridge crossing I-75. Street design will include safe transition points from off-road paths to on-street bike lanes with appropriate wayfinding to make the transitions easy for users.

Reconstruction elements include repaving the road surface, installation of curbs, active transportation features and landscaping enhancements. A new boulevard will also be installed along the section of road from the Norfolk Southern Railway to Jefferson Avenue. Construction started in August between Fort and Melville Streets and will continue along the length of Green Street through Jefferson.

This work is expected to wrap up by the end of fall.





## IN THE COMMUNITY

### GREENHOUSE AND AGRICULTURE INDUSTRY TOUR

In late June, members of the Windsor-Essex Greenhouse and Agriculture industry, attended a project update and bus tour of the Canadian Port of Entry and bridge site. Attendees received a first-hand look at key features on site.



### FOURTH COMMEMORATIVE PATCH NOW AVAILABLE

As part of the project's ongoing patch series, this patch celebrates the completion of the cable installation on the bridge. Pick one up at our community offices in Sandwich and Southwest Detroit open Tuesdays and Thursdays from 10:00 a.m. – 4:00 p.m. Limited quantities of previous patches are available.

**Southwest Detroit Community Office**  
7744 West Vernor Highway  
Detroit, Michigan

**Sandwich Community Office**  
3201 Sandwich Street  
Windsor, Ontario



### SIGN UP TO RECEIVE PROJECT UPDATES

The Gordie Howe International Bridge is transforming how trade moves through Windsor-Detroit and will be open for business soon.

#### Key features of the crossing:

- Highway-to-highway connection
- Six bridge lanes, 16 toll booths and 60 inspection lanes
- Dedicated and dynamic lanes for trucks
- Easy toll collection options
- Faster processing with on-site secondary inspection
- State-of-the-art technology and route optimization tools
- 24/7 operations with tailored customer service
- Real time, accurate and reliable traffic information
- Designed for oversized loads and hazardous materials

Sign up for our email lists to learn more about operations and when customer accounts will become available at

**[GordieHoweInternationalBridge.com](https://GordieHoweInternationalBridge.com).**



Subscribe!

### PUBLIC INFORMATION MEETINGS

September 24, 2025, at our Southwest Detroit Community Office (7744 W Vernor Highway) from 3:00 p.m. – 6:30 p.m.

September 25, 2025, in Windsor at Mackenzie Hall (3277 Sandwich Street) from 3:00 p.m. - 6:30 p.m.

The meetings will provide the latest updates on construction, operations, customer account registration and the Community Benefits Plan.



## NEW COMMUNITY PIER IN SANDWICH

A new community pier in Sandwich Town is now under construction. Located at the foot of Mill Street within Port Windsor's green space, the pier will extend over the Detroit River and is anticipated to provide public access in September.

The new \$2.5 million pier features Indigenous artwork, interpretive signage, QR codes, an expansion of the pedestrian pathway and a ceremonial space curated by First Nations leaders. The project team invested \$980,000 (CDN) into the project from the Community Benefits Plan as part of a call for proposals that occurred in summer 2024. The Community Benefits Plan supports social, environmental and economic enhancements to the communities of Sandwich/west Windsor and Delray/Southwest Detroit.

The land where the pier is located sits on the traditional territory of the Three Fires Confederacy, which consists of the Ojibwe, Odawa and Potawatomi. The pier's layout honours the First Nations tradition of the directional path of learning to encourage thoughtful movement and reflection by having users enter from the left and exit to the right. Once open, the pier will offer a safe space for recreational fishing for the community.

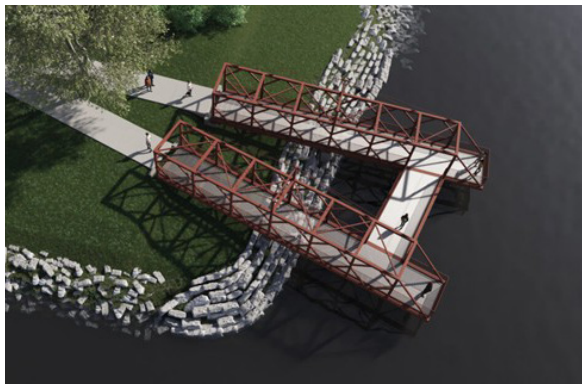

## OHIO FREIGHT CONFERENCE

In July, Gordie Howe International Bridge project staff attended the Ohio Freight Conference in Detroit.

Attendees received a project update then hopped on buses to receive a guided tour of the bridge site and US Port of Entry. Attendees received a look at features and amenities their companies will utilize in the near future.



## KID ZONE

Colour and customize the bike that you would like to ride across the Gordie Howe International Bridge on the multi-use path!

